

RESQ

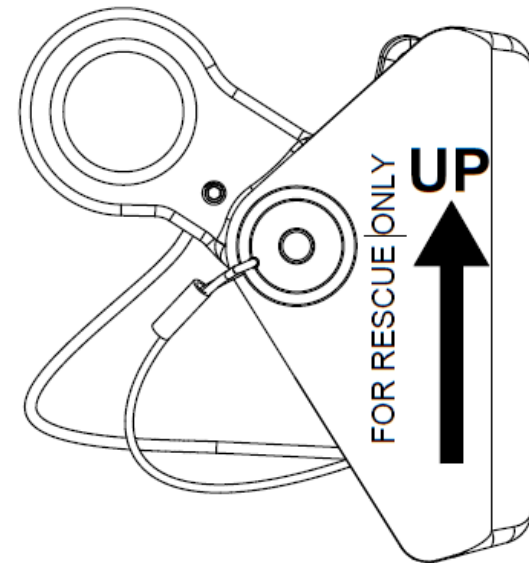

USER INSTRUCTIONS RESCUE ROPE GRAB

 **CRESTO SAFETY**

Cresto Safety
c/o Diabasgatan 16
254 68 Helsingborg
Sweden

crestosafety.com



For your own safety, it is important that you read and fully understand this user instructions!

This user manual provides important information about the correct use of the Rescue rope grab in various situations. It emphasizes the need for all users, including employers, to read and fully understand these instructions to ensure safety and proper use of the product. Users should receive training in the use of the equipment.

Introduction

This rescue rope grab has been designed to make an attachment point on a lanyard with the use of a Rescue and evacuation device in accordance with EN1496 for edge rescue scenarios.

This rescue rope grab is compliant with EN566.

Applicable with a Rescue and evacuation equipment with EN341 and EN1496.

Warning! The equipment shall only be used by a person trained and competent in a safe use.

Warning! The user/-s must be in good physical and mental condition. In case of known disorder, the user must be aware of possible consequences, as conditions such as cardiovascular conditions, diabetes, blood pressure deviations, epilepsy and balance problems or any other medical condition that can be hazardous to the safety using the equipment.

Warning! Do not use the equipment outside its limitations or for no purpose other than that which it is intended.

Warning! The equipment must only be used for rescue and evacuation and not intended as fall arrest equipment.



Warning! For the user's safety the device shall be inspected at least every twelfth month to ensure its functionality and durability (refer to EN 365). The inspection can be registered in Inspector online at www.crestogroup.com

NOTE! In cases of frequent usage of the device or in aggressive environments, inspections shall be carried out at shorter intervals (as decided by a trained competent person).

Warning! The inspection shall be carried out by a competent person (a person who has been trained and is competent in fall protection equipment inspection) who holds a certificate for inspection and in accordance with the manufacturer's inspection procedure as well as EN 365.

Warning! The device must not be modified or supplemented using accessories other than those supplied by the manufacturer. Repairs or replacement of parts may only be carried out by the manufacturer.

Warning! Do not make any alterations or additions to the equipment without the manufacturer's prior written consent, and any repair shall only be carried out in accordance with manufacturer's procedures.

SUSTAINABILITY & RECYCLING.

We design and manufacture premium products, with premium materials, to be used actively and to last long. When the product is decided to be taken out of use, or its maximum life-time has expired, it should be recycled according to your local legislations. Our products are made of polyester, polyamide or PVC and metal components. If necessary, dismantle the metal components before recycling. You can also send the complete product to Cresto Safety and we will take care of the recycling in order to reduce our impact on the environment."

Cresto Group AB, Diabasgatan 16, 254 68 Helsingborg +46 (0)42 563 00, www.cresto.com. Support@cresto.com

Warning! It is essential for the safety of the user that if the product is re-sold outside the original country of destination the reseller shall provide instructions for use, for maintenance, for periodic examination and for repair in the language of the country in which the product is to be used.

Download your user instruction:

<http://www.cresto.com/app/uploads/files/Document/>



Warning! Do not lift or descend a loaded rescue rope grab over an edge as this might slip if caught against the edge.

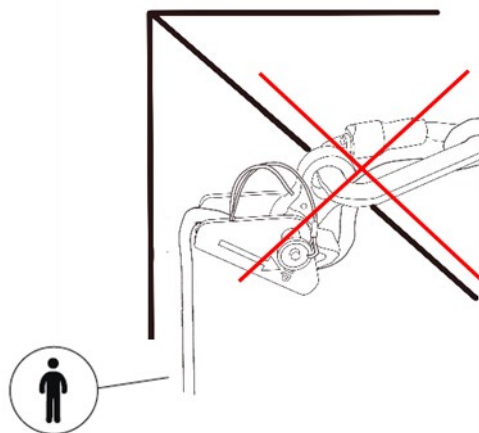

Maintenance and Inspection

Note! During transport and storage, keep the device dark and dry.

Inspection and service of the equipment must be carried out by the manufacturer or a partner who is authorized by the manufacturer and in accordance with the manufacturers guidelines.

If stored, maintained as described and used in normal condition, the expected lifetime is indefinite.

Note! If the equipment is installed at a workstation and left in place between inspections, it must be protected by the RESQ vacuum solution to ensure protection from environmental conditions.

NOTE! The device shall be stored in a dry, dark, and well-ventilated location, protected against steam, sharp edges, vibration and UV-light. The device shall be kept clean for best functionality and durability. Metal parts can be blown clean with compressed air. Avoid lubricating oil! Lightly soiled devices can be washed with a brush in lukewarm water. A mild soap solution can be used. Wet devices are hung up to dry. The device shall be allowed to air-dry without being subjected to open fire or any other heat source.

The device log on the last page must be updated with all periodic inspections, service and repairs and other matters concerning the safe use of the device, if the **CRESTO INSPECTOR** data base is not utilized.



Marking and Illustrations

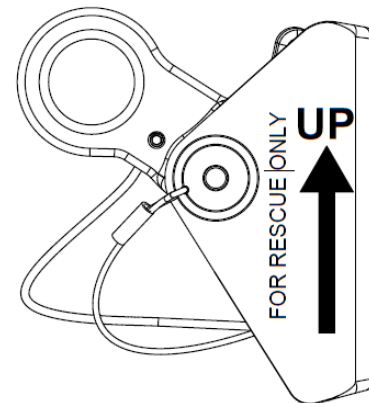
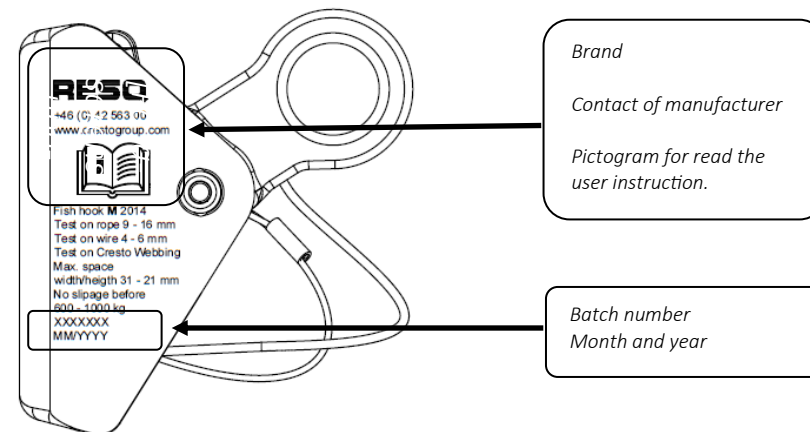

If possible, mark the device with the date of inspection or date for next inspection.

Note! Make sure that the product markings are legible



Before Use

Note! Before use of the equipment always check the function and condition to ensure safe usage. If stored in the Cresto vacuum solution, only check that the vacuum is still intact. If punctured, you must inspect the function and condition of the equipment before use.

Check the Rescue rope grab device for any cracks, deformation, or missing parts. Check the function and spring action of the rope locking mechanism.

Warning! Withdraw the device immediately until confirmed in writing by a competent person if any doubts arise about its condition for safe use or if it has arrested a fall.

Warning! Always use a fall arrest system if there is a risk for fall when rigging the equipment.

Warning! Always ensure that in a fall-arrest system, it is essential to check for clearance below the user before each use, to avoid any impact with the ground or an obstacle in case of a fall.

Make sure that the anchor point is correctly positioned, to limit the risk and the height of fall. When using multiple pieces of equipment together, a dangerous situation can arise if the safety function of one piece of equipment is affected by the safety function of another piece of equipment.

Warning! Extreme temperatures may affect the capacity of the device.

Warning! Protect the rope for any edges that may compromise its integrity.

Compatible with PPE components within EN, ANSI or CSA designed for the purpose.

Note! This must always be in conjunction with the national and local requirements

Only connect to a structure with a minimum strength of 12kN or designed for the purpose. Strive to position as high above as possible and protect from edges that could damage the rope.

Tested on rope 9-16mm; Tested on wire 4-6mm; Tested on Cresto webbing Max width/height 31-21mm. No slippage before 600-1000kg

Technical specification

Type: Fish hook M 2014

For use with:

Rope: Kernmantle rope 9-16mm

Wire: 4-6mm

Cresto Webbing: max width 31mm, max thickness 21mm

Made from aluminium

Compliance: EN566

Max load: 141kg

Min. descent load: 40kg

Max. ambient temperature: +60°C

Min. ambient temperature: -40°C

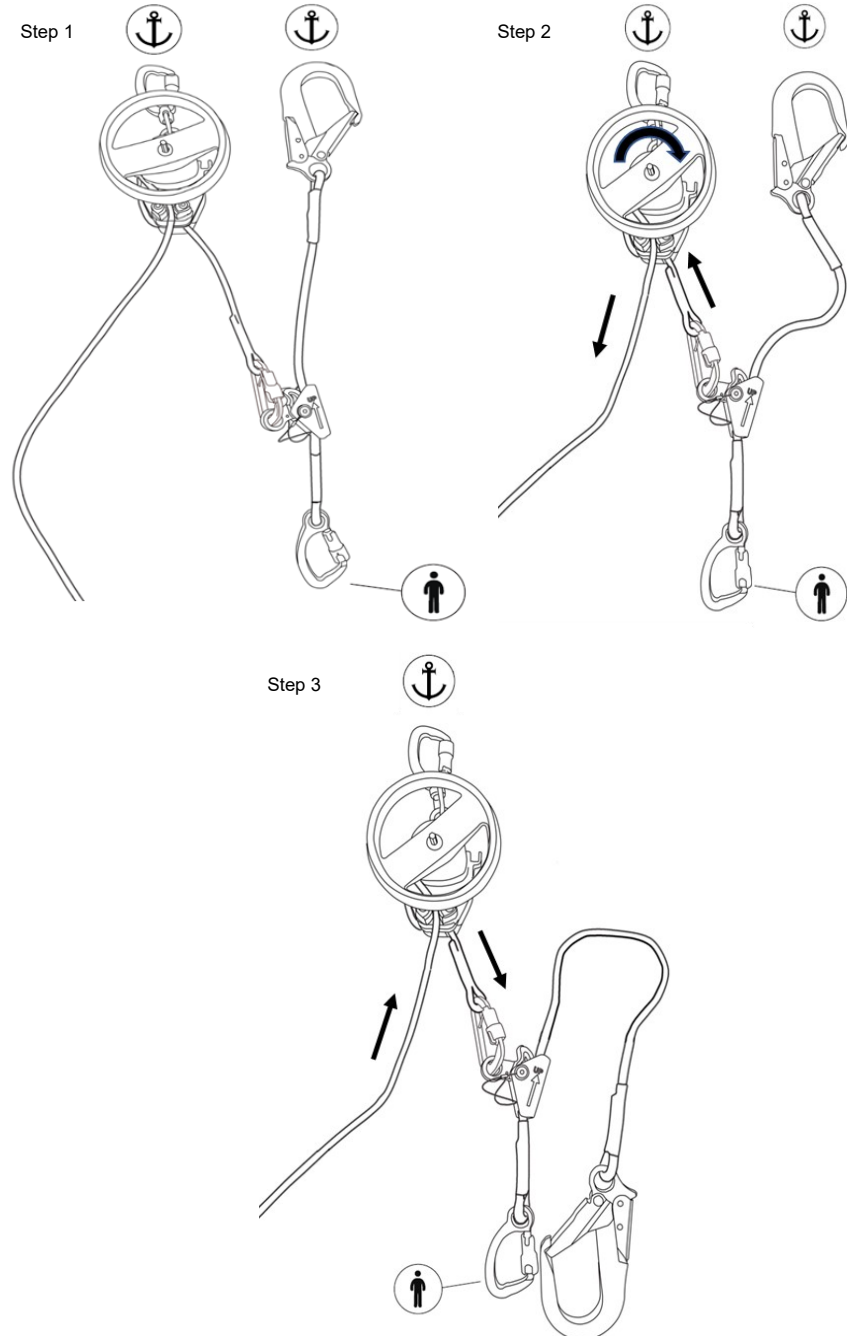

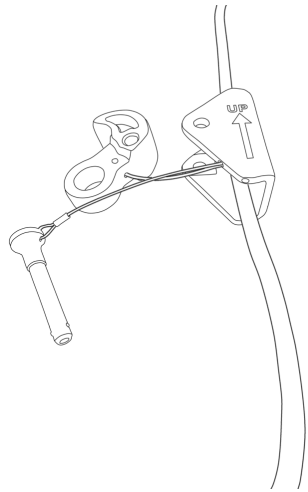

pic. 2

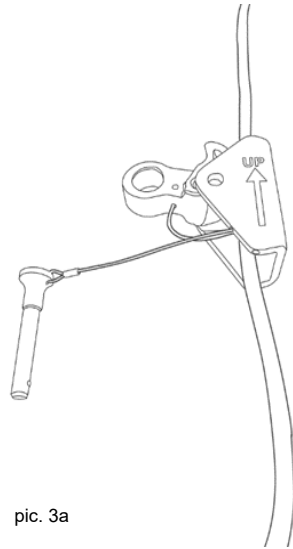

pic. 3a

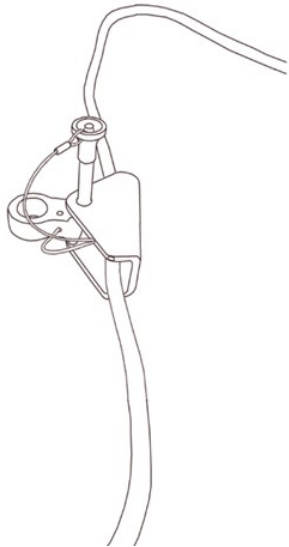

pic. 3b

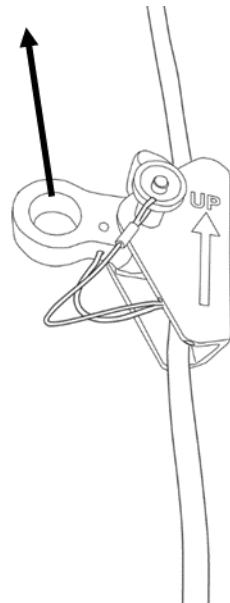

pic. 4



Overview rescue rope grab parts

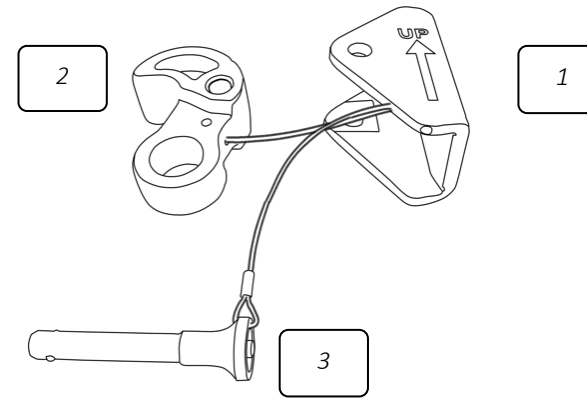

1. Rope grab body
2. Cam
3. Ball pin

Basic general information:

Secure the Rescue rope grab to the carabiner of the Rescue equipment, see pic. 1. Attach the Rescue equipment to an anchor point at least 1,5m from the edge. Mount the Rescue rope grab to the lanyard after the edge of the casualty by pressing the ball pin and pull the pin out to open the rescue rope grab. Place the body of the rescue rope grab with the arrows pointing up, see pic. 2, insert the cam followed by the ball pin, see pic. 3a, 3b and 3c.

Check that it locks by pulling upwards, see pic 3c. Push the rescue rope grab as far as possible towards the casualty.

NOTE! Do not lift a loaded rescue rope grab over an edge as this might slip if caught against the edge. lift the casualty with the rescue device EN1496 until you can release the casualty lanyard connection by hand. Lower with the rescue device until the casualty reaches the ground.

pic. 1.

